

求積表

地番	1 ①				
NO	Xn	Yn	Yn+1-Yn-1	Xn · (Yn+1-Yn-1)	
P4	43847.042	-77065.894	-15.378	-674279.811876	
P5	43845.093	-77079.180	-15.404	-675389.812572	
P6	43844.782	-77081.298	-4.142	-181605.087044	
P7	43858.584	-77083.322	14.496	635774.033664	
P1	43860.983	-77066.802	16.750	734671.465250	
P2	43859.399	-77066.572	3.000	131578.197000	
P3	43859.802	-77063.802	0.678	29736.945756	
合計				485.930178	
合計面積				242.9650890	
地積				242.96	m ²

地番	2 ②				
NO	Xn	Yn	Yn+1-Yn-1	Xn · (Yn+1-Yn-1)	
P8	43856.152	-77100.077	14.726	645825.694352	
P7	43858.584	-77083.322	18.779	823620.348936	
P6	43844.782	-77081.298	-7.731	-338964.009642	
P9	43843.351	-77091.053	-16.750	-734376.129250	
P10	43842.325	-77098.048	-9.024	-395633.140800	
合計				472.763596	
合計面積				236.3817980	
地積				236.38	m ²

地番	3 ③				
NO	Xn	Yn	Yn+1-Yn-1	Xn · (Yn+1-Yn-1)	
A16	43853.719	-77116.831	14.722	645614.451118	
P8	43856.152	-77100.077	18.783	823750.103016	
P10	43842.325	-77098.048	-2.849	-124906.783925	
P11	43841.609	-77102.926	-16.751	-734390.792359	
P12	43839.867	-77114.799	-13.905	-609593.350635	
合計				473.627215	
合計面積				236.8136075	
地積				236.81	m ²

地番	4 ④				
NO	Xn	Yn	Yn+1-Yn-1	Xn · (Yn+1-Yn-1)	
P4	43847.042	-77065.894	12.928	566854.558976	
SR1	43844.854	-77066.252	-0.423	-18546.373242	
K8	43838.461	-77066.317	1.506	66020.722266	
P18	43832.365	-77064.746	-0.649	-28447.204885	
P17	43829.025	-77066.966	-11.869	-520206.697725	
P16	43827.609	-77076.615	-12.214	-535310.416326	
P5	43845.093	-77079.180	10.721	470063.242053	
合計				427.831117	
合計面積				213.9155585	
地積				213.91	m ²

地番	5 ⑤				
NO	Xn	Yn	Yn+1-Yn-1	Xn · (Yn+1-Yn-1)	
P16	43827.609	-77076.615	-9.308	-407947.384572	
P15	43825.867	-77088.488	-14.438	-632757.867746	
P9	43843.351	-77091.053	7.190	315233.693690	
P6	43844.782	-77081.298	11.873	520569.096686	
P5	43845.093	-77079.180	4.683	205326.570519	
合計				424.108577	
合計面積				212.0542885	
地積				212.05	m ²

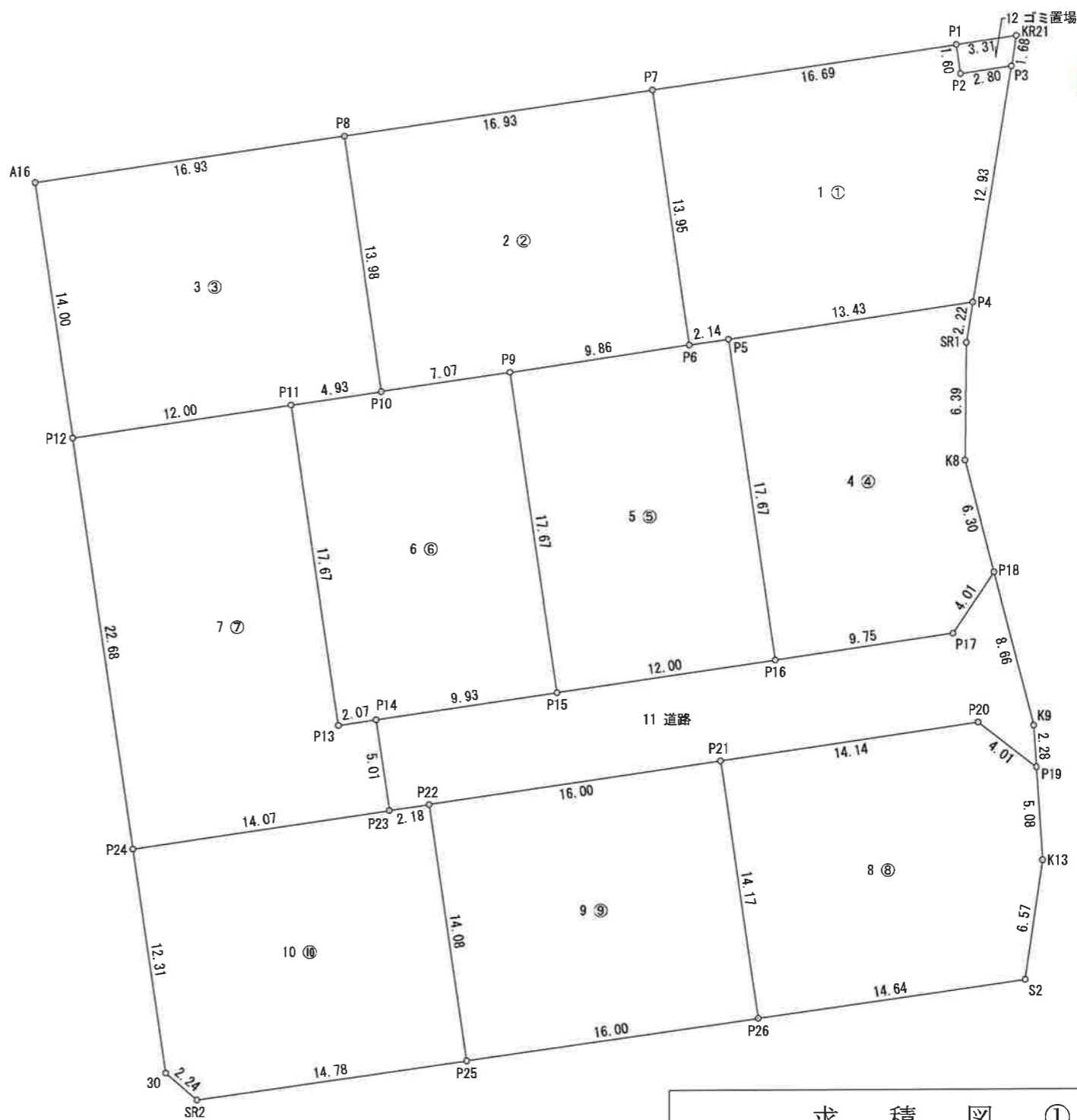

変更後

求積図 ①	
所在	高崎市箕郷町生原字中新田1337-1
縮尺	1/300
作成日	令和6年10月30日
作成者	土地家屋調査士 須長 亮

変更後

求積表

地番 6 ㉔				
NO	Xn	Yn	Yn+1-Yn-1	Xn · (Yn+1-Yn-1)
P15	43825.867	-77088.488	-7.260	-318175.794420
P14	43824.426	-77098.313	-11.873	-520327.409898
P13	43824.125	-77100.361	-4.613	-202160.688625
P11	43841.609	-77102.926	2.313	101405.641617
P10	43842.325	-77098.048	11.873	520539.924725
P9	43843.351	-77091.053	9.560	419142.435560
合計				424.108959
合計面積				212.0544795
地積				212.05 m ²

地番 7 ㉕				
NO	Xn	Yn	Yn+1-Yn-1	Xn · (Yn+1-Yn-1)
P14	43824.426	-77098.313	2.776	121656.606576
P23	43819.469	-77097.585	-13.193	-578110.254517
P24	43817.426	-77111.506	-17.214	-754273.171164
P12	43839.867	-77114.799	8.580	376146.058860
P11	43841.609	-77102.926	14.438	632985.150742
P13	43824.125	-77100.361	4.613	202160.688625
合計				565.079122
合計面積				282.5395610
地積				282.53 m ²

地番 8 ㉖				
NO	Xn	Yn	Yn+1-Yn-1	Xn · (Yn+1-Yn-1)
P19	43821.702	-77062.435	3.500	153375.957000
K13	43816.628	-77062.104	-0.605	-26509.059940
S2	43810.130	-77063.040	-15.437	-676296.976810
P26	43808.086	-77077.541	-16.558	-725374.287988
P21	43822.108	-77079.598	11.937	523104.503196
P20	43824.161	-77065.604	17.163	752154.075243
合計				454.210701
合計面積				227.1053505
地積				227.10 m ²

地番 9 ㉗				
NO	Xn	Yn	Yn+1-Yn-1	Xn · (Yn+1-Yn-1)
P22	43819.785	-77095.429	13.786	604099.556010
P21	43822.108	-77079.598	17.888	783889.867904
P26	43808.086	-77077.541	-13.786	-603938.273596
P25	43805.852	-77093.384	-17.888	-783599.080576
合計				452.069742
合計面積				226.0348710
地積				226.03 m ²

地番 10 ㉘				
NO	Xn	Yn	Yn+1-Yn-1	Xn · (Yn+1-Yn-1)
P25	43805.852	-77093.384	-12.592	-551603.288384
SR2	43803.788	-77108.021	-16.336	-715578.680768
30	43805.250	-77109.720	-3.485	-152661.296250
P24	43817.426	-77111.506	12.135	531724.464510
P23	43819.469	-77097.585	16.077	704485.603113
P22	43819.785	-77095.429	4.201	184086.916785
合計				453.719006
合計面積				226.8595030
地積				226.85 m ²

地番 11 道路				
NO	Xn	Yn	Yn+1-Yn-1	Xn · (Yn+1-Yn-1)
P18	43832.365	-77064.746	4.382	192073.423430
K9	43823.976	-77062.584	2.311	101277.208536
P19	43821.702	-77062.435	-3.020	-132341.540040
P20	43824.161	-77065.604	-17.163	-752154.075243
P21	43822.108	-77079.598	-29.825	-1306994.371100
P22	43819.785	-77095.429	-17.987	-788186.472795
P23	43819.469	-77097.585	-2.884	-126375.348596
P14	43824.426	-77098.313	9.097	398670.803322
P15	43825.867	-77088.488	21.698	950933.662166
P16	43827.609	-77076.615	21.522	943257.800898
P17	43829.025	-77066.966	11.869	520206.697725
合計				367.788303
合計面積				183.8941515
地積				183.89 m ²

地番 2 ゴミ置場				
NO	Xn	Yn	Yn+1-Yn-1	Xn · (Yn+1-Yn-1)
KR21	43861.458	-77063.530	3.000	131584.374000
P3	43859.802	-77063.802	-3.042	-133421.517684
P2	43859.399	-77066.572	-3.000	-131578.197000
P1	43860.983	-77066.802	3.042	133425.110286
合計				9.769602
合計面積				4.8848010
地積				4.88 m ²

総合計面積	2505.5118780 m ²
-------	-----------------------------

求積図 ㉙	
所在	高崎市箕郷町生原字中新田1337-1
縮尺	1/300
作成日	令和6年10月30日
作成者	土地家屋調査士 須長 亮